

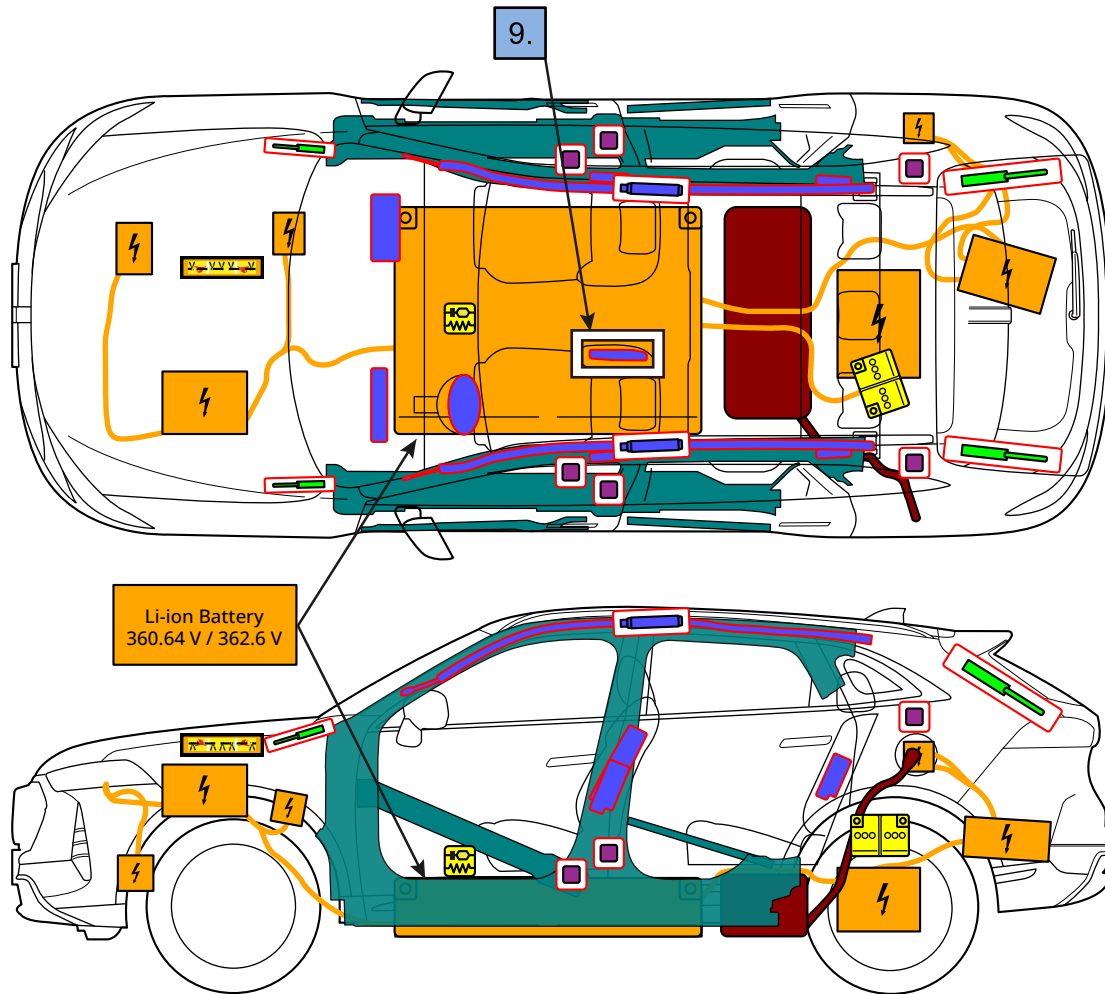

GWM WEY 05 (COFFEE 01)
SUV
From 2022



Legend

	Airbag		Stored gas inflator		Seat belt pretensioner		SRS control unit		Battery low voltage
	Gas strut/Preloaded spring		High strength zone		Zone requiring special attention		Battery pack, high voltage		High voltage power cable
	Cable cut		Fuel tank content gasoline/ethanol		High voltage component				

This overview shows the maximum range of equipment of the vehicle.

ID No.	Version No.	Page No.
LGW-WEY-V71PHEVG	V2	1/4



GWM WEY 05 (COFFEE 01)
SUV
From 2022



1. Identification / recognition



LACK OF ENGINE NOISE DOES NOT MEAN VEHICLE IS OFF. SILENT MOVEMENT OR INSTANT RESTART CAPABILITY EXISTS UNTIL VEHICLE IS FULLY SHUT DOWN. WEAR APPROPRIATE PPE.

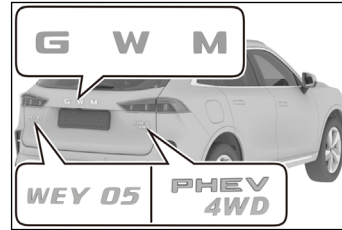
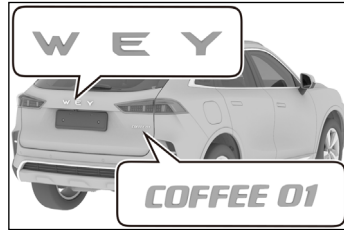

2. Immobilisation / stabilisation / lifting

Immobilise and stabilise the vehicle

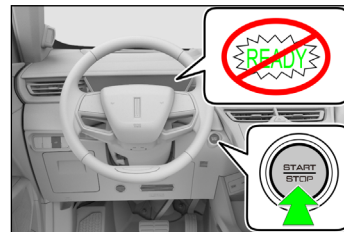
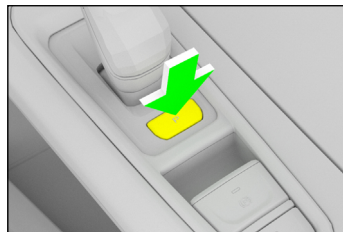
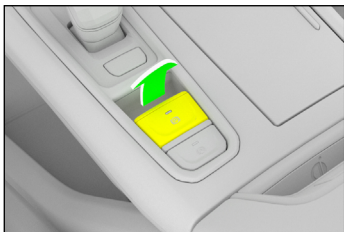

Lifting points

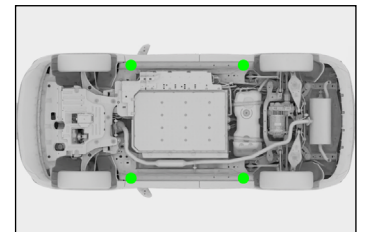

- Apply parking brake;
- Press "P" button;
- Shut power off.

3. Disable direct hazards / safety regulations

DISABLING METHOD

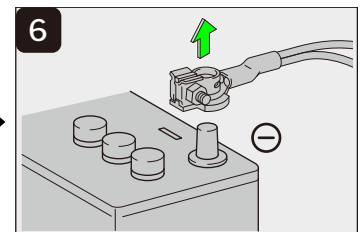
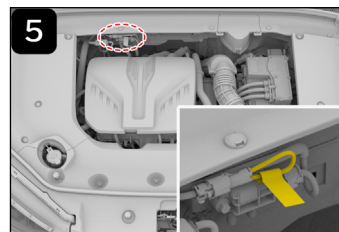
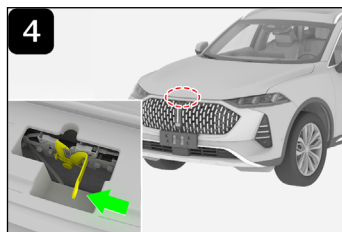
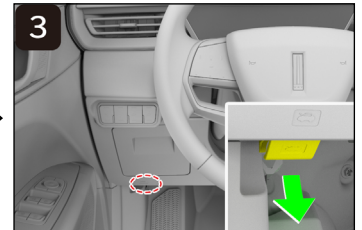
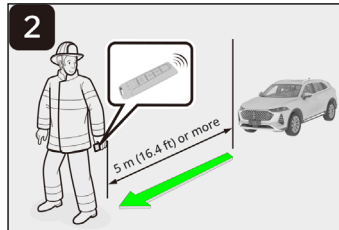
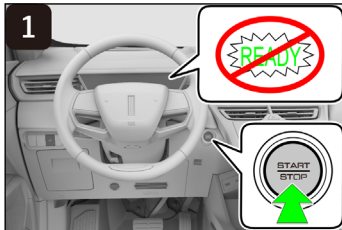
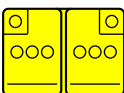
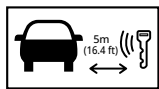

ACCESS TO 12V BATTERY

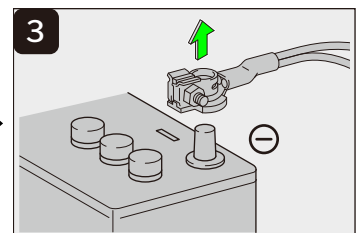
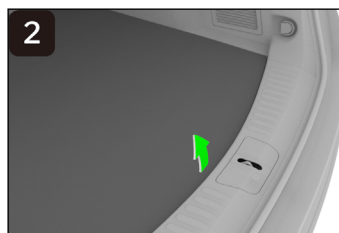
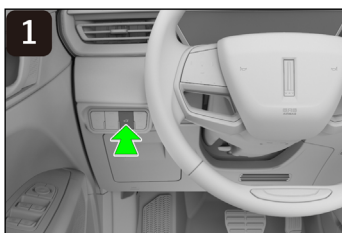
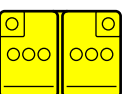

This overview shows the maximum range of equipment of the vehicle.

ID No.

Version No.

Page No.

LGW-WEY-V71PHEVG

V2

2/4



GWM WEY 05 (COFFEE 01)
SUV
From 2022



4. Access to the occupants

High strength zone

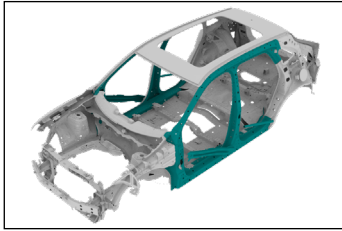

Seat adjustment

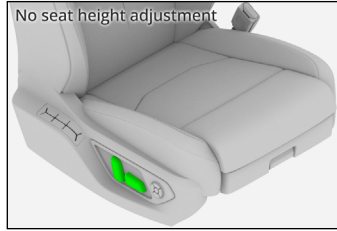
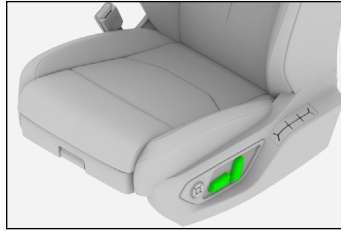

Steering column adjustment

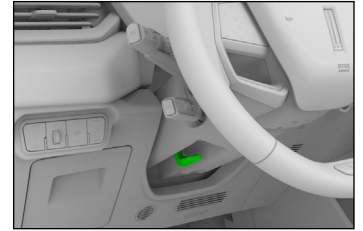

WHEN THE 12 V BATTERY IS DISCONNECTED, ELECTRICAL COMPONENTS CANNOT BE OPERATED.

Glass types

Tempered glass
Laminated glass

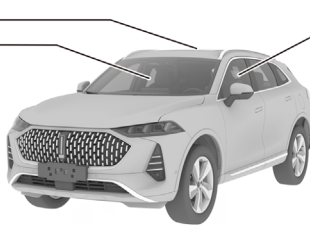

Laminated glass



Tempered glass

5. Stored energy / liquids / gases / solids

		12 V Battery
		360.64 V / 362.6 V
		55 L
		680±10 g

6. In case of fire



USE LARGE AMOUNTS OF WATER.

If it is difficult to apply copious amounts of water to the high voltage battery, it is recommended to allow the high voltage battery to burn itself out.

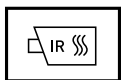

BATTERY RE-IGNITION!



7. In case of submersion

Proper personal protective equipment should be worn when handling any flooded vehicle. Pull the vehicle out of water as much as possible, immobilise the vehicle and disable the vehicle before starting any operation (see chapter 3).

Tilt the vehicle to one side to allow water to drain out of the vehicle.

This overview shows the maximum range of equipment of the vehicle.

ID No.

Version No.

Page No.

LGW-WEY-V71PHEVG

V2

3/4



GWM WEY 05 (COFFEE 01)
SUV
From 2022



8. Towing / transportation / storage

Location front hook

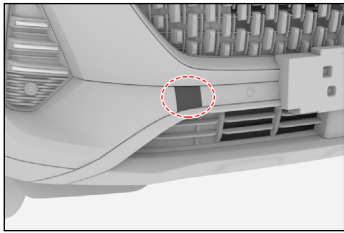

Location rear hook

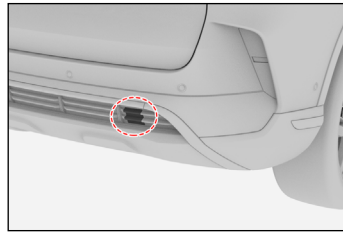

STORE AT SAFE DISTANCE FROM OTHER VEHICLES!



BATTERY RE-IGNITION!

9. Important additional information

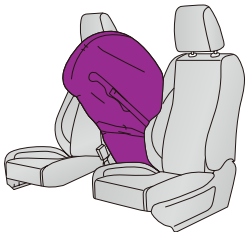

Driver's seat has a far side airbag in addition to the side airbag. Location of far side airbag is shown in the mark **9.** on page 1.

10. Explanation of pictograms used

Pictogram	Designation	Pictogram	Designation	Pictogram	Designation
	Remove smart key		Flammable		Hazardous to the human health
	Boot		Explosive		Use water to extinguish the fire
	Bonnet		Corrosives		Warning, Electricity
	Air-conditioning component		Use thermal Infrared camera		General warning sign

This overview shows the maximum range of equipment of the vehicle.

ID No.

Version No.

Page No.

LGW-WEY-V71PHEVG

V2

4/4